



## Product Catalog



# CAD/CAM

## Materials



# Table of Contents

<b>Milling Tools</b>	<b>3</b>
Zirconia	4
Cobalt Chromium	5
Titanium	7
PMMA and Wax	9
Glass and Hybrid Ceramic	10
Special	10
<b>Milling Disc Comparison</b>	<b>11</b>
<b>Zirconia Milling Discs</b>	<b>13</b>
Upcera ST White	13
Upcera Explore Functional	14
Upcera Explore Esthetic	16
Vita YZ® ST Color	18
Vita YZ ST MultiColor	20
<b>Metal Milling Discs</b>	<b>22</b>
Zfx™ Titanium G5	22
Zfx Cobalt Chromium	23
Zfx Cobalt Chromium Eco	24
<b>Other</b>	<b>25</b>
Zfx PMMA Splint Milling Discs	25
Zfx Scan Dry Lab	26

# Milling Tool Overview

Zfx offers optimized dental milling tools, refined over 100,000 applications, featuring diverse cutting geometries and coatings that balance tool lifespan, cost, and processing time for cost-effective, high-quality results. These tools cover a wide range of materials and applications.

Indications			
	Zirconia	Cobalt Chromium	Titanium
Crown	•	•	•
Bridge	•	•	•
Partial Crown	•	•	•
Primary Telescope	•	•	•
Inlay, Onlay	•	•	•
Veneer	•	•	•
Splint (Bitesplint)	•		
Hybrid Structure	•	•	•
Implant Attachment	•	•	•
Model Cast	•	•	
Stumps / Model	•	•	

Indications		
	PEEK	Glass and Hybrid Ceramic
Crown	•	•
Bridge	•	•
Partial Crown	•	•
Primary Telescope	•	•
Inlay, Onlay	•	•
Veneer	•	•
Splint (Bitesplint)	•	
Hybrid Structure	•	
Implant Attachment	•	
Model Cast		
Stumps / Model		

# Zirconia Milling Tools

Solid carbide milling tools with the latest generation diamond coating ensure the excellent edge stability and running performance in wet and dry processing.



## Zirconia (ZrO<sub>2</sub>) Milling Tools

Tool ID	ø Cutter (d1)	Length (l1)	Insert length (l2)	Item No.
T20	2.00 mm	45 mm	20 mm	ZFX06000467
T15	1.50 mm	42 mm	15 mm	ZFX06000466
T10	1.00 mm	42 mm	10 mm	ZFX06000465
T5	0.60 mm	42 mm	6 mm	ZFX06000464



### Indications

- Crown: anatomically reduced and fully anatomical
- Bridge: anatomically reduced and fully anatomical
- Partial crown
- Primary telescope
- Inlay, Onlay: anatomically reduced and fully anatomical
- Veneer

## ZrO<sub>2</sub> Milling Tools for Screw-Retained Constructions

Tool ID	ø Cutter (d1)	Length (l1)	Insert length (l2)	Item No.
T20	2.00 mm	45 mm	20 mm	ZFX06000467
T15	1.50 mm	42 mm	15 mm	ZFX06000466
T10	1.00 mm	42 mm	10 mm	ZFX06000465
T5	0.60 mm	42 mm	6 mm	ZFX06000464
T51	1.00 mm	45 mm	10 mm	ZFX06002300
T42	2.00 mm	50 mm	20 mm	ZFX06002290
T41	1.50 mm	50 mm	20 mm	ZFX06002280



### Indications

- Titanium-based hybrid abutment (2-piece abutment): anatomically reduced and fully anatomical
- Screw-retained bridge at multi-unit level: anatomically reduced and fully anatomical
- Titanium-based hybrid abutment (2-piece abutment bridge): anatomically reduced and fully anatomical

# Cobalt Chromium Milling Tools

Solid carbide milling tools with special coatings and cutting geometries for all work steps, from coarse filing to finishing and fine finishing. The tools are suitable for wet and dry processing.



## Cobalt Chromium (CoCr) Milling Tools

Tool ID	ø Cutter (d1)	Length (l1)	Insert length (l2)	Item No.
T221	2.00 mm	40 mm	11.5 mm	ZFX06000519
T214	1.50 mm	40 mm	6 mm	ZFX06000480
T201	1.00 mm	40 mm	6 mm	ZFX06000478
T189	0.50 mm	40 mm	1.5 mm	ZFX06000479
T153	2.00 mm	40 mm	12 mm	ZFX06001244
T111	1.50 mm	40 mm	8 mm	ZFX06000476
T100	1.00 mm	40 mm	4 mm	ZFX06000481
T203	1.00 mm	45 mm	10 mm	ZFX06000493
T113	1.50 mm	45 mm	12 mm	ZFX06000494

### Indications

- Crown: anatomically reduced and fully anatomical
- Bridge: anatomically reduced and fully anatomical
- Partial crown
- Primary telescope
- Inlay, Onlay: anatomically reduced and fully anatomical





## CoCr Milling Tools for Screw-Retained Constructions

Tool ID	ø Cutter (d1)	Length (l1)	Insert length (l2)	Item No.
T221	2.00 mm	40 mm	11.5 mm	ZFX06000519
T214	1.50 mm	40 mm	6 mm	ZFX06000480
T201	1.00 mm	40 mm	6 mm	ZFX06000478
T189	0.50 mm	40 mm	1.5 mm	ZFX06000479
T153	2.00 mm	40 mm	12 mm	ZFX06001244
T111	1.50 mm	40 mm	8 mm	ZFX06000476
T100	1.00 mm	40 mm	4 mm	ZFX06000481
T409	1.50 mm	50 mm	21 mm	ZFX06002250
T260	1.00 mm	40 mm	4 mm	ZFX06002234
T176	1.00 mm	40 mm	6 mm	ZFX06002238
T171	1.50 mm	40 mm	4 mm	ZFX06002237
T170	1.00 mm	40 mm	2.5 mm	ZFX06002236
T158	1.50 mm	45 mm	15 mm	ZFX06000496
T156	1.50 mm	45 mm <td 16 mm	ZFX06000498	
T154	2.00 mm	45 mm	16 mm	ZFX06000507
T151/ T251	1.50 mm	40 mm	8 mm	ZFX06002235
T155	2.00 mm	45 mm	20 mm	ZFX06002233
T159	1.50 mm	50 mm	20 mm	ZFX06002330
T259	0.40 mm	40 mm	3 mm	ZFX06002239

### Indications

- Titanium-based hybrid abutment (2-piece abutment): anatomically reduced and fully anatomical
- Screw-retained bridge at multi-unit level: anatomically reduced and fully anatomical
- Titanium-based hybrid abutment (2-piece abutment bridge): anatomically reduced and fully anatomical



# Titanium Milling Tools

Solid carbide milling tools with special coating for safe and efficient milling of titanium and pre-abutments.



## Titanium (Ti) Milling Tools

Tool ID	ø Cutter (d1)	Length (l1)	Insert length (l2)	Item No.
T621	2.00 mm	40 mm	11.5 mm	ZFX06000490
T614	1.50 mm	40 mm	6 mm	ZFX06000488
T601	1.00 mm	40 mm	6 mm	ZFX06000486
T589	1.50 mm	40 mm	1.5 mm	ZFX06000487
T511	1.50 mm	40 mm	8 mm	ZFX06000484
T500	1.00 mm	40 mm	4 mm	ZFX06000489
T153	2.00 mm	40 mm	12 mm	ZFX06001244
T203	1.00 mm	45 mm	10 mm	ZFX06000493
T113	1.50 mm	45 mm	12 mm	ZFX06000494



### Indications

- Crown: anatomically reduced and fully anatomical
- Bridge: anatomically reduced and fully anatomical
- Partial crown
- Primary telescope
- Inlay, Onlay: anatomically reduced and fully anatomical

## Ti Pre-milled Blank Milling Tools

Tool ID	ø Cutter (d1)	Length (l1)	Insert length (l2)	Item No.
T621	2.00 mm	40 mm	11.5 mm	ZFX06000490
T511	1.50 mm	40 mm	8 mm	ZFX06000484
T153	2.00 mm	40 mm	12 mm	ZFX06001244
T151/ T251	1.50 mm	40 mm	8 mm	ZFX06002235



### Indications

- Individual abutment made from pre-manufactured abutment blank



## Ti Milling for Screw-Retained Constructions

Tool ID	∅ Cutter (d1)	Length (l1)	Insert length (l2)	Item No.
T621	2.00 mm	40 mm	11.5 mm	ZFX06000490
T614	1.50 mm	40 mm	6 mm	ZFX06000488
T601	1.00 mm	40 mm	6 mm	ZFX06000486
T589	1.50 mm	40 mm	1.5 mm	ZFX06000487
T511	1.50 mm	40 mm	8 mm	ZFX06000484
T500	1.00 mm	40 mm	4 mm	ZFX06000489
T153	2.00 mm	40 mm	12 mm	ZFX06001244
T409	1.50 mm	50 mm	21 mm	ZFX06002250
T260	1.00 mm	40 mm	4 mm	ZFX06002234
T176	1.00 mm	40 mm	6 mm	ZFX06002238
T171	1.50 mm	40 mm	4 mm	ZFX06002237
T170	1.00 mm	40 mm	2.5 mm	ZFX06002236
T158	1.50 mm	45 mm	15 mm	ZFX06000496
T156	1.50 mm	45 mm	16 mm	ZFX06000498
T154	2.00 mm	45 mm	16 mm	ZFX06000507
T151/ T251	1.50 mm	40 mm	8 mm	ZFX06002235
T155	2.00 mm	45 mm	20 mm	ZFX06002233
T159	1.50 mm	50 mm	20 mm	ZFX06002330
T259	0.40 mm	40 mm	3 mm	ZFX06002239

### Indications

- Titanium-based hybrid abutment (2-piece abutment): anatomically reduced and fully anatomical
- Screw-retained bridge at multi-unit level: anatomically reduced and fully anatomical
- Titanium-based hybrid abutment (2-piece abutment bridge): anatomically reduced and fully anatomical



# PMMA and Wax Milling Tools

Special cutting geometries for high-performance milling of all common plastics from the dental industry.



## PMMA Milling Tools

Tool ID	ø Cutter (d1)	Length (l1)	Insert length (l2)	Item No.
T21	2.00 mm	42 mm	15 mm	ZFX06000954
T16	1.50 mm	42 mm	10 mm	ZFX06000473
T11	1.00 mm	42 mm	8 mm	ZFX06000472
T6	0.60 mm	42 mm	6 mm	ZFX06000953



### Indications

- Crown: anatomically reduced and fully anatomical
- Bridge: anatomically reduced and fully anatomical
- Partial crown
- Primary telescope
- Veneer
- Splint (Bite-Splint)
- Inlay, Onlay: anatomically reduced and fully anatomical

## PMMA Milling Tools for Screw-retained Constructions

Tool ID	ø Cutter (d1)	Length (l1)	Insert length (l2)	Item No.
T21	2.00 mm	42 mm	15 mm	ZFX06000954
T16	1.50 mm	42 mm	10 mm	ZFX06000473
T11	1.00 mm	42 mm	8 mm	ZFX06000472
T6	0.60 mm	42 mm	6 mm	ZFX06000953
T409	1.50 mm	50 mm	21 mm	ZFX06002250
T260	1.00 mm	40 mm	4 mm	ZFX06002234
T176	1.00 mm	40 mm	6 mm	ZFX06002238
T171	1.50 mm	40 mm	4 mm	ZFX06002237
T170	1.00 mm	40 mm	2.5 mm	ZFX06002236
T158	1.50 mm	45 mm	15 mm	ZFX06000496
T156	1.50 mm	45 mm	16 mm	ZFX06000498
T154	2.00 mm	45 mm	16 mm	ZFX06000507
T151/ T251	1.50 mm	40 mm	8 mm	ZFX06002235
T155	2.00 mm	45 mm	20 mm	ZFX06002233
T159	1.50 mm	50 mm	20 mm	ZFX06002330
T259	0.40 mm	40 mm	3 mm	ZFX06002239

### Indications

- Titanium-based hybrid abutment (2-piece abutment): anatomically reduced and fully anatomical
- Screw-retained bridge at multi-unit level: anatomically reduced and fully anatomical
- Titanium-based hybrid abutment bridge (2-piece abutment bridge): anatomically reduced and fully anatomical



# Glass and Hybrid Ceramic Milling Tools

Grinding pins with extremely high quality diamond coating in different grain sizes for coarse filing, finishing and fine finishing.



## Glass and Hybrid Ceramic Milling Tools

Tool ID	ø Cutter (d1)	Length (l1)	Insert length (l2)	Item No.
T126	2.00 mm	40 mm	12 mm	ZFX06000512
T125	1.00 mm	40 mm	10 mm	ZFX06000520
T124	0.50 mm	40 mm	10 mm	ZFX06000521
T128	2.00 mm	42 mm	17 mm	ZFX06T128



### Indications

- Crown: anatomically reduced and fully anatomical
- Partial crown
- Primary telescope
- Inlay, Onlay: anatomically reduced and fully anatomical
- Titanium-based hybrid abutment (2-piece abutment): anatomically reduced and fully anatomical
- Veneer

# Special Milling Tools

Special tools for milling geometries.

## Special Milling Tools

Tool ID	ø Cutter (d1)	Length (l1)	Insert length (l2)	Item No.
T113	1.50 mm	45 mm	12 mm	ZFX06000494
T155	2.00 mm	45 mm	20 mm	ZFX06002233
T159	1.50 mm	50 mm	20 mm	ZFX06002330
T180	0.30 mm	40 mm	2 mm	ZFX06001084
T190	0.50 mm	40 mm	3.5 mm	ZFX06000495
T203	1.00 mm	45 mm	10 mm	ZFX06000493
T259	0.40 mm	40 mm	3 mm	ZFX06002239
T83	1.60 mm	40 mm	7.5 mm	ZFX06T83
T82	1.45 mm	40 mm	6.5 mm	ZFX06T82

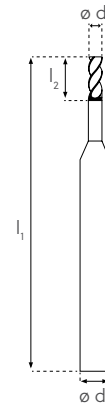

# Zirconia Disc Comparison



## Zirconia Blanks Indications

Product	Veneer/ Inlay/ Onlay	Cutback Anterior Crown	Full Contour Anterior Crown	Cutback Posterior Crown	Full Contour Posterior Crown	Cutback 3-unit Bridge	Full Contour Anterior 3-unit Bridge	Full Contour Posterior 3-unit Bridge	Cutback Long-span Bridge	Full Contour Long-span Bridge	Implant Crown	Implant Full Arch
Vita YZ ST Color	○	○	●	○	●	○	●	●	○	●	●	●
Vita YZ ST Multicolor	○	○	●	○	●	○	●	●	○	●	●	●
Upcera ST White	○	●	○	●	○	●	○	○	●	○	○	○
Upcera Functional Explore	○	○	●	○	●	●	○	○	●	●	●	●
Upcera Esthetic Explore	●	○	●	○	●	○	●	●	●	●	●	●

● Recommended ○ Available ● Not Advised

## Zirconia Blanks Material Properties and Features

Product	CTE (25 - 500°C) (10 <sup>-6</sup> K <sup>-1</sup> )	Fracture Toughness (SEVNB) (MPa√m)*	Flexural Strength (MPa)	Translucence	Multi-layered	Shaded	Bleach Shade	Max disc thickness
Vita YZ ST Color	10.3	3.5	1200	46%	x	√	x	25 mm
Vita YZ ST Multicolor	10.3	3.5	1200	46%	√	√	x	22 mm
Upcera ST White	10.5	Not specified	>1200	43%	x	x	x	25 mm
Upcera Functional Explore	10.5	4.3-5.1	1027-1300	43-46.6%	√	√	x	22 mm
Upcera Esthetic Explore	10.5	3.5-4.3	727-1000	47-48.8%	√	√	√	22 mm

\*Determined using 3-point bending test.

# Metal Disc Comparison



## Metal Blanks Indications

Product	Crown Superstructure	Bridge Superstructure	Implant-retained Superstructure	Implant Abutment	Implant Bar
Zfx Titanium G5	●	●	●	●	●
Zfx Cobalt Chromium	●	●	●	●	●
Zfx Cobalt Chromium Eco	●	●	●	×	×

● Recommended    × Not Indicated

## Metal Blanks Material Properties and Features

Product	E modulus (GPa)	CTE (25 - 500°C) (10 <sup>-6</sup> K <sup>-1</sup> )	Hardness (HV) 10/30	Tensile Strength (MPa)	Density (g/cm <sup>3</sup> )
Zfx Titanium G5	174	10.3	318	885	4.4
Zfx Cobalt Chromium	240	14.5	275	819	8.55
Zfx Cobalt Chromium Eco	250	14.4	350	610	8.8

# Upcera ST White

Upcera ST White is a super-translucent, unstained 3Y-TZP dental zirconia blank with high strength and good translucency, making it a versatile "general purpose" material suitable for a wide range of indications.



## Physical Properties

CTE (25 - 500°C)	$10^{-6} \text{ K}^{-1}$	10.5
Flexural Strength	MPa	>1200
Translucence	%	43

## Upcera ST white

Diameter d (mm)	Height h (mm)	Item No.
98	14	D98-14
98	16	D98-16
98	18	D98-18
98	20	D98-20
98	22	D98-22
98	25	D98-25

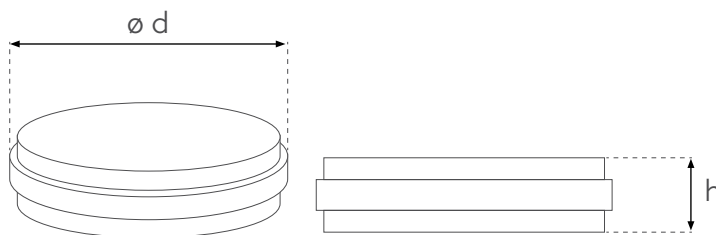

## Recommended Indications

- Cutback Anterior Crown
- Cutback Posterior Crown
- Cutback 3-unit Bridge
- Cutback Long-span Bridge

## Other Indications

- Veneer/Inlay/Onlay
- Full-Contour Anterior Crown
- Full-Contour Posterior Crown
- Full-Contour Anterior 3-unit Bridge
- Full-Contour Posterior 3-unit Bridge
- Full-Contour Long-span Bridge
- Implant Crown
- Implant Full Arch

# Upcera Explore Functional

Upcera Explore Functional is a 5-layer dental multilayer zirconia (3Y-TZP & 4Y-PSZ) that provides a seamless gradient of chroma, translucency, strength, and toughness, making it a versatile material suitable for all indications, including long-span bridges and full arch restorations.



## Physical Properties

CTE (25 - 500°C)	10 <sup>-6</sup> K <sup>-1</sup>	10.5
Fracture Toughness (SEVNB)*	MPa√m	4.3-5.1
Flexural Strength	MPa	1027-1300
Translucence	%	43-46.6

\*Determined using 3-point bending test.

## Layered Structure (% of disc thickness)

Incisal Layer	23%
Transitional Layer 1	18%
Transitional Layer 2	18%
Transitional Layer 3	18%
Body Layer	23%

## Colors

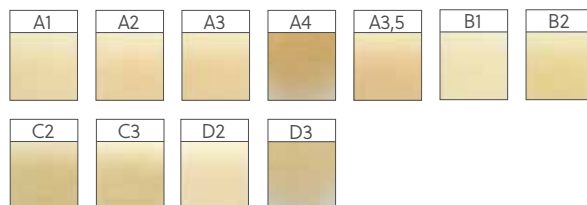

## Recommended Indications

- Full-Contour Anterior Crown
- Full-Contour Posterior Crown
- Cutback 3-unit Bridge
- Full-Contour Posterior 3-unit Bridge
- Cutback Long-span Bridge
- Full-Contour Long-span Bridge
- Implant Crown
- Implant Full Arch

## Other Indications

- Veneer/Inlay/Onlay
- Cutback Anterior Crown
- Cutback Posterior Crown
- Full-Contour Anterior 3-unit Bridge

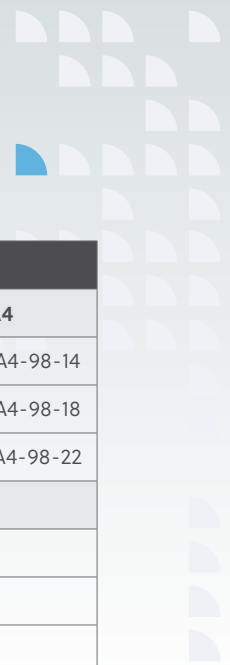

## Upcera Explore Functional

Diameter d (mm)	Height h (mm)	Color/Item No.				
		A1	A2	A3	A3.5	A4
98	14	FU-ML-A1-98-14	FU-ML-A2-98-14	FU-ML-A3-98-14	FU-ML-A35-98-14	FU-ML-A4-98-14
98	18	FU-ML-A1-98-18	FU-ML-A2-98-18	FU-ML-A3-98-18	FU-ML-A35-98-18	FU-ML-A4-98-18
98	22	FU-ML-A1-98-22	FU-ML-A2-98-22	FU-ML-A3-98-22	FU-ML-A35-98-22	FU-ML-A4-98-22
		B1	B2			
98	14	FU-ML-B1-98-14	FU-ML-B2-98-14			
98	18	FU-ML-B1-98-18	FU-ML-B2-98-18			
98	22	FU-ML-B1-98-22	FU-ML-B2-98-22			
			C2	C3		
98	14		FU-ML-C2-98-14	FU-ML-C3-98-14		
98	18		FU-ML-C2-98-18	FU-ML-C3-98-18		
98	22		FU-ML-C2-98-22	FU-ML-C3-98-22		
			D2	D3		
98	14		FU-ML-D2-98-14	FU-ML-D3-98-14		
98	18		FU-ML-D2-98-18	FU-ML-D3-98-18		
98	22		FU-ML-D2-98-22	FU-ML-D3-98-22		

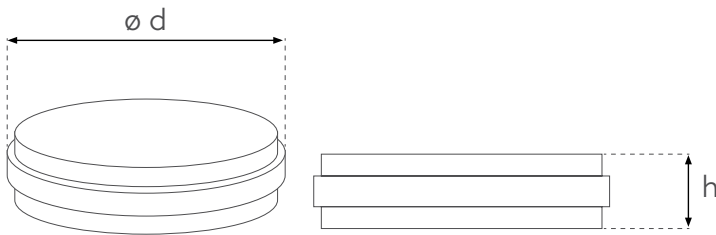

# Upcera Explore Esthetic

Upcera Explore Esthetic is a 4Y-PSZ & 5Y-PSZ multilayered, pre-shaded dental zirconia puck that offers a seamless gradient of translucency, strength, chroma, and toughness, making it ideal for highly esthetic anterior restorations like crowns, bridges, and veneers.



## Physical Properties

CTE (25 - 500°C)	10 <sup>-6</sup> K <sup>-1</sup>	10.5
Fracture Toughness (SEVNB)*	MPa√m	3.5-4.3
Flexural Strength	MPa	727-1000
Translucence	%	47-48.8

\*Determined using 3-point bending test.

## Layered Structure (% of disc thickness)

Incisal Layer	23%
Transitional Layer 1	18%
Transitional Layer 2	18%
Transitional Layer 3	18%
Body Layer	23%

## Colors

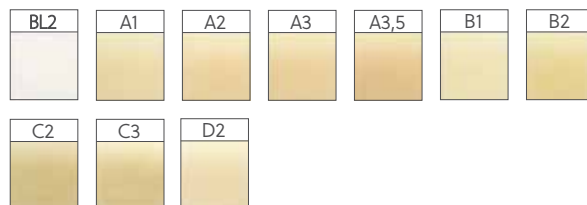

## Recommended Indications

- Veneer/Inlay/Onlay
- Full-Contour Anterior Crown
- Full-Contour Posterior Crown
- Full-Contour Anterior 3-unit Bridge
- Full-Contour Posterior 3-unit Bridge
- Implant Crown

## Other Indications

- Cutback Anterior Crown
- Cutback Posterior Crown
- Cutback 3-unit Bridge



## Upcera Explore Esthetic

Diameter d (mm)	Height h (mm)	Color/Item No.			
			<b>BL2</b>		
98	14		ES-ML-BL2-98-14		
98	18		ES-ML-BL2-98-18		
98	22		ES-ML-BL2-98-22		
		<b>A1</b>	<b>A2</b>	<b>A3</b>	<b>A3.5</b>
98	14	ES-ML-A1-98-14	ES-ML-A2-98-14	ES-ML-A3-98-14	ES-ML-A35-98-14
98	18	ES-ML-A1-98-18	ES-ML-A2-98-18	ES-ML-A3-98-18	ES-ML-A35-98-18
98	22	ES-ML-A1-98-22	ES-ML-A2-98-22	ES-ML-A3-98-22	ES-ML-A35-98-22
		<b>B1</b>	<b>B2</b>		
98	14	ES-ML-B1-98-14	ES-ML-B2-98-14		
98	18	ES-ML-B1-98-18	ES-ML-B2-98-18		
98	22	ES-ML-B1-98-22	ES-ML-B2-98-22		
			<b>C2</b>	<b>C3</b>	
98	14		ES-ML-C2-98-14	ES-ML-C3-98-14	
98	18		ES-ML-C2-98-18	ES-ML-C3-98-18	
98	22		ES-ML-C2-98-22	ES-ML-C3-98-22	
			<b>D2</b>		
98	14		ES-ML-D2-98-14		
98	18		ES-ML-D2-98-18		
98	22		ES-ML-D2-98-22		

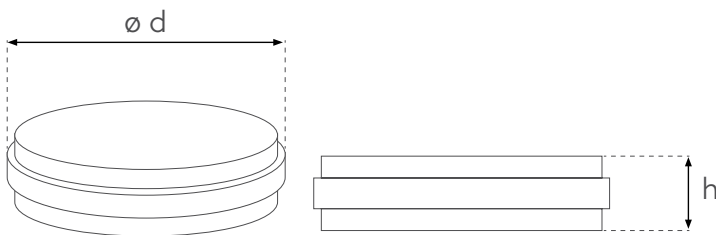

# Vita YZ ST Color

Vita YZ ST Color is a super-translucent, pre-shaded dental zirconia blank (4Y-TZP) with high flexural strength and translucency, enabling precise and efficient reproduction of Vita shades for monolithic and partially veneered posterior tooth restorations.



## Physical Properties

E modulus	GPa	210
CTE (25 - 500°C)	10 <sup>-6</sup> K <sup>-1</sup>	10.3
Fracture Toughness (SEVNB)*	MPa√m	3.5
Flexural Strength	MPa	1200
Translucence	%	46

\*Determined using 3-point bending test.

## Recommended Indications

- Full-Contour Anterior Crown
- Full-Contour Posterior Crown
- Full-Contour Anterior 3-unit Bridge
- Full-Contour Posterior 3-unit Bridge
- Full-Contour Long-span Bridge
- Implant Crown
- Implant Full Arch

## Colors

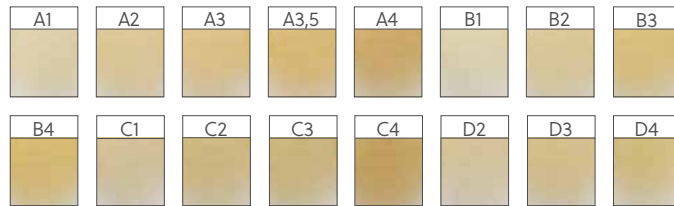

## Other Indications

- Veneer/Inlay/Onlay
- Cutback Anterior Crown
- Cutback Posterior Crown
- Cutback 3-unit Bridge
- Cutback Long-span Bridge



## Vita YZ ST Color

Diameter d (mm)	Height h (mm)	Color/Item No.				
		A1	A2	A3	A3.5	A4
98.4	14	EDCYS7981436	EDCYS7981437	EDCYS7981438	EDCYS7981439	EDCYS7981440
98.4	18	EDCYS7981836	EDCYS7981837	EDCYS7981838	EDCYS7981839	EDCYS7981840
98.4	20	EDCYS7982036	EDCYS7982037	EDCYS7982038	EDCYS7982039	EDCYS7982040
98.4	25	EDCYS7982536	EDCYS7982537	EDCYS7982538	EDCYS7982539	EDCYS7982540
		B1	B2	B3		B4
98.4	14	EDCYS7981441	EDCYS7981442	EDCYS7981443		EDCYS7981444
98.4	18	EDCYS7981841	EDCYS7981842	EDCYS7981843		EDCYS7981844
98.4	20	EDCYS7982041	EDCYS7982042	EDCYS7982043		EDCYS7982044
98.4	25	EDCYS7982541	EDCYS7982542	EDCYS7982543		EDCYS7982544
		C1	C2	C3		C4
98.4	14	EDCYS7981445	EDCYS7981446	EDCYS7981447		EDCYS7981448
98.4	18	EDCYS7981845	EDCYS7981846	EDCYS7981847		EDCYS7981848
98.4	20	EDCYS7982045	EDCYS7982046	EDCYS7982047		EDCYS7982048
98.4	25	EDCYS7982545	EDCYS7982546	EDCYS7982547		EDCYS7982548
			D2	D3		D4
98.4	18		EDCYS7981849	EDCYS7981850		EDCYS7981851

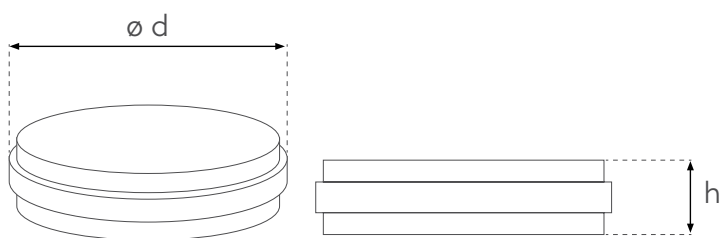

# Vita YZ ST Multicolor

Vita YZ ST Multicolor is a super-translucent, pre-shaded, multilayered dental zirconia blank (4Y-TZP) with high flexural strength and translucency, offering integrated shade and translucency gradients for efficient and precise reproduction of Vita shades.



## Physical Properties

E modulus	GPa	210
CTE (25 - 500°C)	10 <sup>-6</sup> K <sup>-1</sup>	10.3
Fracture Toughness (SEVNB)*	MPa√m	3.5
Flexural Strength	MPa	1200
Translucence	%	46

\*Determined using 3-point bending test.

## Recommended Indications

- Full-Contour Anterior Crown
- Full-Contour Posterior Crown
- Full-Contour Anterior 3-unit Bridge
- Full-Contour Posterior 3-unit Bridge
- Full-Contour Long-span Bridge
- Implant Crown
- Implant Full Arch

## Layered Structure (% of disc thickness)

Incisal Layer 1	23%
Incisal Layer 2	10%
Transitional Layer 2	10%
Transitional Layer 3	19%
Body Layer 1	19%

## Other Indications

- Veneer/Inlay/Onlay
- Cutback Anterior Crown
- Cutback Posterior Crown
- Cutback 3-unit Bridge
- Cutback Long-span Bridge

## Colors

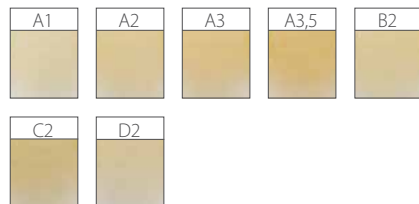

## Vita YZ ST Multicolor

Diameter d (mm)	Height h (mm)	Color/Item No.			
		A1	A2	A3	A3.5
98.4	14	EDMYS7981436	EDMYS7981437	EDMYS7981438	EDMYS7981439
98.4	18	EDMYS7981836	EDMYS7981837	EDMYS7981838	EDMYS7981839
98.4	22	EDMYS7982236	EDMYS7982237	EDMYS7982238	EDMYS7982239
			<b>B2</b>		
98.4	14		EDMYS7981442		
98.4	18		EDMYS7981842		
98.4	20		EDMYS7982242		
			<b>C2</b>		
98.4	14		EDMYS7981446		
98.4	18		EDMYS7981846		
98.4	20		EDMYS7982246		
			<b>D2</b>		
98.4	14		EDMYS7981449		
98.4	18		EDMYS7981849		
98.4	20		EDMYS7982249		

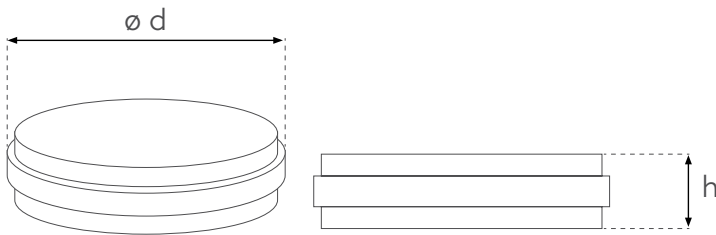

# Zfx Titanium G5

This high-quality titanium alloy impresses with its consistent quality and its high fracture and hardness values. The titanium blank is therefore ideally suitable for the production of crowns and bridges in the anterior and posterior areas, and for implant and bar constructions. Any commercially available veneer ceramic can be used for veneering.



## Physical Properties

E modulus	GPa	174
CTE (25 - 500°C)	10 <sup>-6</sup> K <sup>-1</sup>	10.3
Hardness (HV)	10/30	318
Tensile Strength	MPa	885
Density	g/cm <sup>3</sup>	4.4

## Recommended Indications

- Crown Superstructure
- Bridge Superstructure
- Implant-retained Superstructure
- Implant Abutment
- Implant Bar

## Chemical Composition

Titanium	~90 %
Ferrum	0.13 %
Aluminium	6.0 %
Vanadium	4.1 %
Oxygen	0.1 %
Hydrogen	0.001 %
Nitrogen	0.01 %
Carbon	0.03 %

## ZFX Titanium G5

Diameter d (mm)	Height h (mm)	Item No.
98	10	ZFX08000710
98	12	ZFX08000712
98	14	ZFX08000714
98	15	ZFX08000715
98	16	ZFX08000716
98	18	ZFX08000718
98	20	ZFX08000720
98	25	ZFX08000725

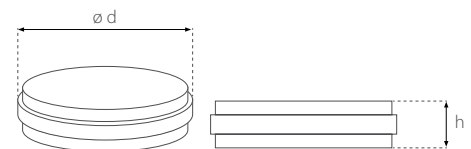

# Zfx Cobalt Chromium

Zfx Cobalt Chromium is a nickel and beryllium-free, venerable non-precious milling alloy made from cobalt chromium. The material can be used to produce crowns and bridges, one-piece abutments and implant-supported suprastructures. Due to its reduced hardness, the CoCr blank is ideal for milling and ceramic veneering.



## Physical Properties

E modulus	GPa	240
CTE (25 - 500°C)	10 <sup>-6</sup> K <sup>-1</sup>	14.5
Hardness (HV)	10/30	275
Tensile Strength	MPa	819
Density	g/cm <sup>3</sup>	8.55

## Recommended Indications

- Crown Superstructure
- Bridge Superstructure
- Implant-retained Superstructure
- Implant Bar

## Chemical Composition

Cobalt	50-70%
Chromium	19-30%
Silicon	0-2%

## ZFX Cobalt Chromium

Diameter d (mm)	Height h (mm)	Item No.
98	10	ZFX08000561
98	12	ZFX08000562
98	13.5	ZFX08000563
98	15	ZFX08000564
98	18	ZFX08000565
98	20	ZFX08000609
98	24.5	ZFX08000566

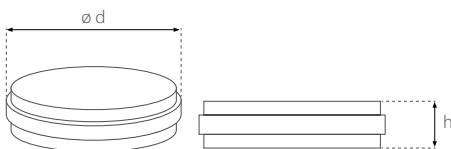

# Zfx Cobalt Chromium Eco

With the industrially manufactured Zfx Cobalt Chromium Eco Blanks, Zfx is able to provide a cost-effective alternative for the production of high-quality dental prosthetics. It is characterized by having excellent milling properties and low milling tool wear. The nickel and beryllium-free blanks are suitable for single crowns as well as for complex implant restorations or ceramic veneering.



## Physical Properties

E modulus	GPa	250
CTE (25 - 500°C)	$10^{-6} K^{-1}$	14.4
Hardness (HV)	10/30	350
Tensile Strength	MPa	610
Density	$g/cm^3$	8.8

## Recommended Indications

- Crown Superstructure
- Bridge Superstructure
- Implant-retained Superstructure

## Chemical Composition

Cobalt	50-100%
Chromium	25-50%

## ZFX Cobalt Chromium

Diameter d (mm)	Height h (mm)	Item No.
98	10	ZFX08000810
98	12	ZFX08000812
98	13.5	ZFX08000813
98	15	ZFX08000815
98	18	ZFX08000818
98	20	ZFX08000820

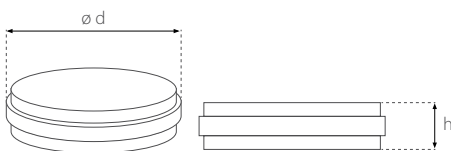

# Zfx PMMA Splint

This industrially polymerised thermoplastic PMMA, which consists of carbon chains, is characterized by its high fracture and flexural strength. The outstanding body compatibility makes it ideal for allergy sufferers. The material is extremely color-stable and has a high degree of translucency. The dense material microstructure provides resistance to staining.



## Physical Properties

Density	g/cm <sup>3</sup>	1.17
Flexural Strength	MPa	92
Water Absorption	µg/mm <sup>3</sup>	0.2
Solubility	g/mm <sup>3</sup>	0.0

## Recommended Indications

- Splint
- Bite Regulator
- Implant Drilling Guide

## ZFX PMMA Splint

Diameter d (mm)	Height h (mm)	Item No.
98	15	ZFX08002000
98	20	ZFX08002001

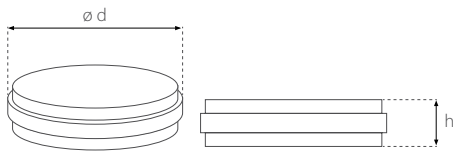

## Zfx Scan Dry Lab

Zfx Scan Spray prevents reflection when scanning, and is used to mark the contact points of prosthetic work. The raw materials which are used are food-compatible and can be removed with water without leaving residue.



### Scan Dry Lab

Description	Size	Item No.
Zfx scan spray	75 ml	ZFX02000278
Zfx scan spray	200 ml	ZFX02001248
Zfx scan spray Superfine	200 ml	ZFX02001250



For more information visit [ZimVie.com](http://ZimVie.com)

ZimVie US Corp LLC  
4555 Riverside Drive  
Palm Beach Gardens, FL 33410  
Tel: +1-561-776-6700  
Fax: +1-561-776-1272  
[dentalCS@ZimVie.com](mailto:dentalCS@ZimVie.com)



Unless otherwise indicated, as referenced herein, all trademarks and intellectual property rights are the property of ZimVie Inc. and its affiliates; and all products are manufactured by one or more of the dental subsidiaries of ZimVie US Corp LLC (Biomet 3i, LLC, etc.) and distributed by ZimVie US Corp LLC and its authorized marketing partners. Zfx GmbH is a subsidiary of ZimVie. Vita YZ® is a registered trademark of VUTA Zahnfabrik AG. EU Medical device classification: Milling Discs (Class IIa). The Intended purpose of Milling Discs is to create or provide support to prosthetic restorations. The products here shown are not eligible for reimbursement in France. For other countries, please check the local laws and regulation. For additional product information, please refer to the individual product labeling or instructions for use. Product clearance and availability may be limited to certain countries/regions. This material is intended for clinicians only and does not comprise medical advice or recommendations. Distribution to any other recipient is prohibited. This material may not be copied or reprinted without the express written consent of ZimVie. ZV2982-GLBL REV B 10/25 ©2025 ZimVie. All rights reserved.



The NB number applicable to each device can be found on the product label, if applicable.